

SCALE:  $1/4" = 1'-0"$

- NOTES:**
- 1) GENERAL CONTRACTOR TO VERIFY OPENING DIMENSIONS W/ SELECTED WINDOW MANUFACTURER BEFORE POURING EXTERIOR CONCRETE WALLS.
  - 2) REFER TO DOORS & WINDOW PRODUCT APPROVALS FOR APPROPRIATE FASTENING.
  - 3) RAILING, WINDOW, EXTERIOR DOORS, STAIRS & HURRICANE SHUTTERS REQUIRE PRODUCT CONTROL APPROVAL (NOA'S) & WINDOW PERMITS (APPROVAL IN COUNTY)
  - 4) SEE EMERGENCY ESCAPE & RESCUE NOTES (SECTION 1029) ON SHEET A4.00
  - 5) SEE DETAILS AND INFORMATION ON SHEET AX.XX.

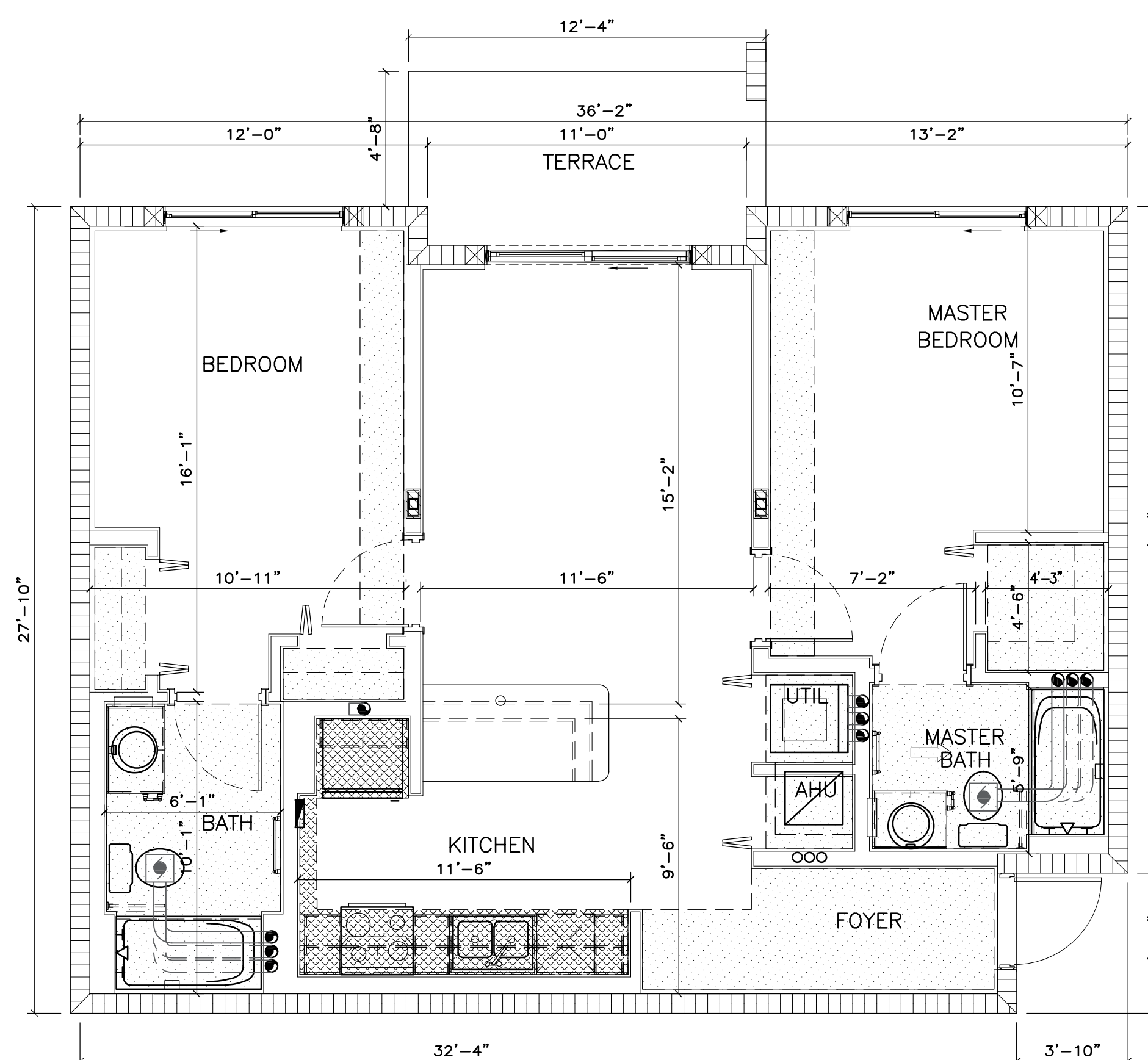

SCALE: 1/4" = 1'-0"

SCALE: 1/4" = 1'-0"

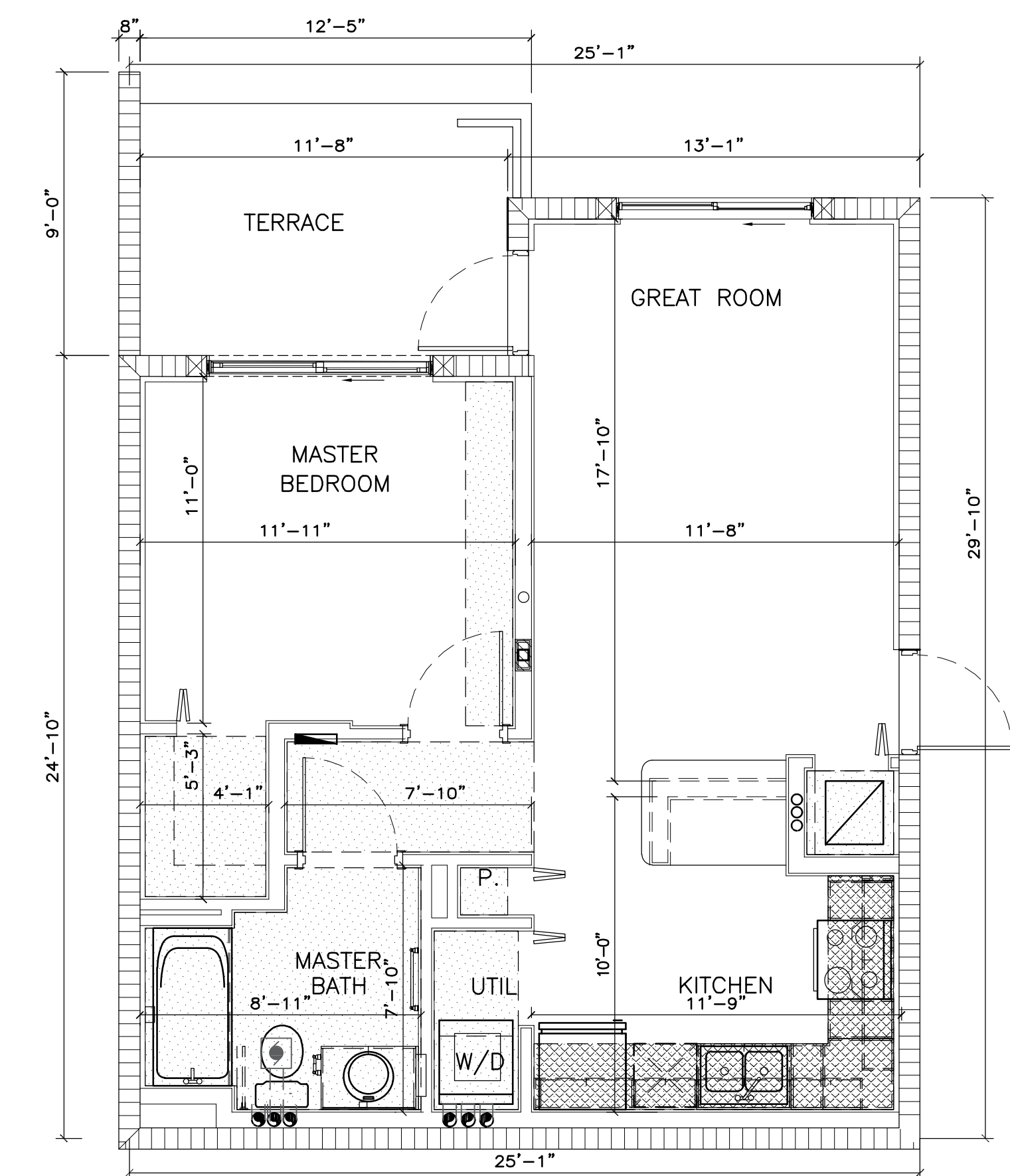

SCALE: 1/4" = 1'-0"

[illegible]

# GALEWAY LUXURY APARTMENTS

LOCATED AT:  
950 N POWERLINE ROAD

POMPANO BEACH F

CARLOS LIZA & ASSOCIATES  
 1248 S ALHAMBRA CIRCLE  
 CORAL GABLES, FL 33146  
 (786) 554-9035  
 AIA 38052598  
 WWW.BURGOSLANZA.COM

1248 S ALHAMBRA CIRC  
CORRAL GABLES, FL 33144  
(786) 554-9035  
AIA 38052598  
[WWW.BURGOSLANZA.COM](http://WWW.BURGOSLANZA.COM)  
PABLO BURGOS ARCHITECT AR 009592



**BUNKUS  
LANZA**  
**ARCHITECTS & PLANNERS**  
AA 26001519

ablo  
urgos

Digitally signed by Pablo Burgos  
 cn=Pablo Burgos, o=Burgos  
 Lanza & Assoc., ou=AR95925,  
 email=pburgos@burgoslanza.co  
 c=US  
 Date: 2022.05.11 14:47:18 -04'00'

TE	11/09/21
AWN	CR
OBJECT No.	2203
ALE	AS-SHOWN

SALE 1/4" = 1' - 0"

4.00

00008

PZ22-12000008  
6/15/2022

# DRC

PZ22-12000008  
8/17/2022

PZ22-12000008  
6/15/2022